

Inland Bank Center

2201-2237 South Wolf Road in Hillside, IL



DEMOGRAPHICS

Population

1 Mile	8,273
3 Mile	101,386
5 Mile	317,700

Average HH Income

1 Mile	\$70,664
3 Mile	\$91,017
5 Mile	\$92,207

- Inland Bank Center is a 25,496 SF retail center
- Opportunities Available for LEASE:
 - Unit #3 - 1,500 SF
 - Unit #4 - 1,516 SF
- 100+ parking spaces
- Join Inland Bank & Trust, Jimmy John's, The UPS Store, and Verizon Wireless
- High traffic location with excellent visibility
- Traffic Counts:
 - Cermak Road - 30,500 VPD
 - Wolf Road - 20,200 VPD
- 7,500 daytime employees in the immediate area
- Minutes to I-294, I-290, Oak Brook, Hinsdale, Burr Ridge, Oakbrook Center, and the Brookfield Zoo
- Area co-tenants include Walgreens, Jewel-Osco, Dominick's, US Cellular, Chase Bank, FedEx Office, Morton's the Steakhouse, Panchero's Mexican Grill, Starbucks, Dunkin' Donuts, Giordano's, Panera Bread, and Subway

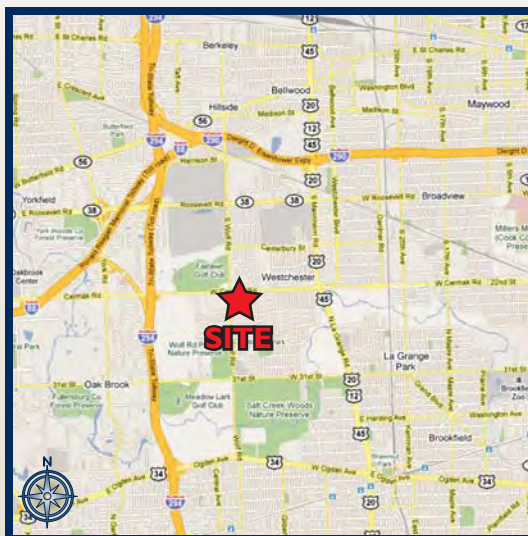

P. Scott Janos

312.254.0723

sjanos@sierraus.com

640 North LaSalle Boulevard

Suite 410

Chicago, IL 60654

312.422.7745 (fax)

www.SierraUS.com

Project Leasing • Restaurant & Entertainment • Tenant Representation
Urban Retail • Office Brokerage • Asset Management



Inland Bank Center - Hillside, IL

current site plan and tenant list

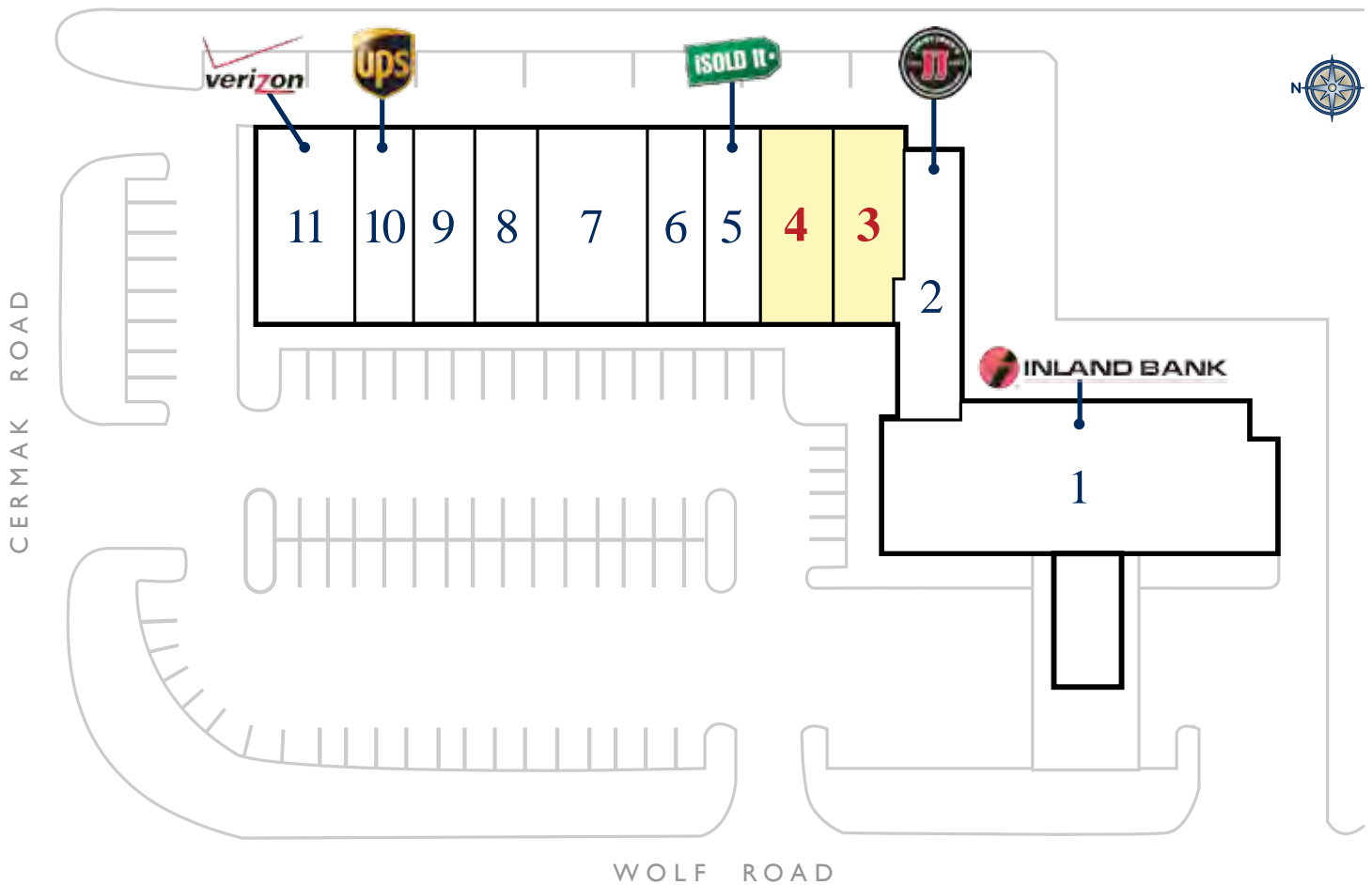

<u>Unit #</u>	<u>Tenant</u>	<u>SF</u>
1	Inland Bank & Trust	8,500
2	Jimmy John's	1,430
3	AVAILABLE	1,500
4	AVAILABLE	1,516
5	I Sold It On Ebay	1,400
6	Impact Signs	1,400
7	Prima La Pizza	2,800
8	Royal Cleaners	1,400
9	Chrysanthy's Salon & Spa	1,400
10	The UPS Store	1,300
11	Verizon Wireless	2,850



Inland Bank Center - Hillside, IL

photos of center



FULL DEMOGRAPHIC PROFILE

1990 - 2000 Census, 2007 Estimates & 2012 Projections

Calculated using Proportional Block Groups



Lat/Lon: 41.847263/-87.9014315

July 2010

RF1

2201-2237 S Wolf Rd Hillside, Illinois		1.00 mi radius	3.00 mi radius	5.00 mi radius
POPULATION	2007 Estimated Population	8,273	101,386	317,700
	2012 Projected Population	8,076	99,645	315,771
	2000 Census Population	8,687	105,153	323,522
	1990 Census Population	8,932	104,086	314,183
	Historical Annual Growth 1990 to 2007	-0.4%	-0.2%	0.1%
	Projected Annual Growth 2007 to 2012	-0.5%	-0.3%	-0.1%
HOUSEHOLDS	2007 Est. Households	3,581	37,592	112,818
	2012 Proj. Households	3,464	36,591	111,028
	2000 Census Households	3,816	39,632	116,831
	1990 Census Households	3,635	38,890	115,023
	Historical Annual Growth 1990 to 2007	-0.1%	-0.2%	-0.1%
	Projected Annual Growth 2007 to 2012	-0.7%	-0.5%	-0.3%
AGE	2007 Est. Population 0 to 9 Years	10.0%	13.7%	14.0%
	2007 Est. Population 10 to 19 Years	8.4%	12.7%	13.5%
	2007 Est. Population 20 to 29 Years	8.3%	8.7%	10.2%
	2007 Est. Population 30 to 44 Years	19.5%	21.1%	20.8%
	2007 Est. Population 45 to 59 Years	22.1%	22.0%	21.5%
	2007 Est. Population 60 to 74 Years	19.1%	13.1%	12.2%
	2007 Est. Population 75 Years Plus	12.5%	8.7%	7.8%
	2007 Est. Median Age	46.4	40.4	38.6
MARITAL STATUS & SEX	2007 Est. Male Population	47.0%	47.5%	48.2%
	2007 Est. Female Population	53.0%	52.5%	51.8%
	2007 Est. Never Married	21.1%	23.8%	26.3%
	2007 Est. Now Married	56.9%	56.0%	53.2%
	2007 Est. Separated or Divorced	9.2%	11.5%	12.6%
	2007 Est. Widowed	12.8%	8.8%	7.9%
INCOME	2007 Est. HH Income \$200,000 or More	4.5%	9.5%	9.6%
	2007 Est. HH Income \$150,000 to 199,999	6.2%	6.3%	6.4%
	2007 Est. HH Income \$100,000 to 149,999	20.2%	18.0%	16.6%
	2007 Est. HH Income \$75,000 to 99,999	16.6%	16.0%	15.2%
	2007 Est. HH Income \$50,000 to 74,999	19.8%	18.7%	18.6%
	2007 Est. HH Income \$35,000 to 49,999	15.0%	12.1%	12.0%
	2007 Est. HH Income \$25,000 to 34,999	7.2%	7.4%	7.9%
	2007 Est. HH Income \$15,000 to 24,999	7.3%	6.8%	7.4%
	2007 Est. HH Income \$0 to 14,999	3.3%	5.3%	6.3%
	2007 Est. Average Household Income	\$ 70,664	\$ 91,017	\$ 92,207
	2007 Est. Median HH Income	\$ 72,437	\$ 79,607	\$ 78,950
	2007 Est. Per Capita Income	\$ 32,104	\$ 34,841	\$ 33,749
	2007 Est. Number of Businesses	396	5,846	15,675
2007 Est. Total Number of Employees	7,671	92,033	224,288	

This report was produced using data from private and government sources deemed to be reliable. The information herein is provided without representation or warranty.

FULL DEMOGRAPHIC PROFILE

1990 - 2000 Census, 2007 Estimates & 2012 Projections

Calculated using Proportional Block Groups



Lat/Lon: 41.847263/-87.9014315

July 2010

RF1

2201-2237 S Wolf Rd Hillside, Illinois		1.00 mi radius	3.00 mi radius	5.00 mi radius
RACE	2007 Est. White Population	78.5%	66.4%	68.6%
	2007 Est. Black Population	10.2%	22.6%	17.5%
	2007 Est. Asian & Pacific Islander	4.8%	4.2%	4.8%
	2007 Est. American Indian & Alaska Native	0.0%	0.1%	0.1%
	2007 Est. Other Races Population	6.5%	6.8%	9.0%
HISPANIC	2007 Est. Hispanic Population	710	8,955	46,795
	2007 Est. Hispanic Population Percent	8.6%	8.8%	14.7%
	2012 Proj. Hispanic Population Percent	11.4%	11.4%	17.0%
	2000 Hispanic Population Percent	4.6%	5.5%	11.8%
EDUCATION (Adults 25 or Older)	2007 Est. Adult Population (25 Years or Older)	6,432	70,140	213,454
	2007 Est. Elementary (0 to 8)	3.7%	3.5%	5.0%
	2007 Est. Some High School (9 to 11)	5.0%	4.8%	5.4%
	2007 Est. High School Graduate (12)	27.6%	25.1%	24.5%
	2007 Est. Some College (13 to 16)	19.5%	20.1%	19.6%
	2007 Est. Associate Degree Only	7.7%	7.2%	7.1%
	2007 Est. Bachelor Degree Only	21.1%	23.7%	22.6%
	2007 Est. Graduate Degree	15.5%	15.6%	15.8%
	HOUSING	2007 Est. Total Housing Units	3,894	41,179
2007 Est. Owner Occupied Percent		83.6%	76.7%	72.0%
2007 Est. Renter Occupied Percent		8.3%	14.6%	19.0%
2007 Est. Vacant Housing Percent		8.1%	8.7%	8.9%
HOMES BUILT BY YEAR	2000 Homes Built 1999 to 2000	1.3%	0.6%	0.9%
	2000 Homes Built 1995 to 1998	0.7%	1.4%	1.9%
	2000 Homes Built 1990 to 1994	5.7%	3.1%	2.8%
	2000 Homes Built 1980 to 1989	14.3%	4.5%	5.4%
	2000 Homes Built 1970 to 1979	8.9%	8.5%	11.5%
	2000 Homes Built 1960 to 1969	18.6%	15.5%	15.3%
	2000 Homes Built 1950 to 1959	38.2%	36.8%	28.3%
	2000 Homes Built Before 1949	12.3%	29.8%	34.0%
HOME VALUES	2000 Home Value \$1,000,000 or More	0.0%	1.1%	1.6%
	2000 Home Value \$500,000 to \$999,999	1.0%	5.1%	6.4%
	2000 Home Value \$400,000 to \$499,999	2.6%	4.0%	4.7%
	2000 Home Value \$300,000 to \$399,999	5.3%	8.6%	8.4%
	2000 Home Value \$200,000 to \$299,999	26.8%	18.4%	18.6%
	2000 Home Value \$150,000 to \$199,999	42.6%	25.8%	24.3%
	2000 Home Value \$100,000 to \$149,999	19.5%	29.4%	28.1%
	2000 Home Value \$50,000 to \$99,999	2.1%	7.2%	7.4%
	2000 Home Value \$25,000 to \$49,999	-	0.2%	0.3%
	2000 Home Value \$0 to \$24,999	0.2%	0.3%	0.2%
	2000 Median Home Value	\$ 190,007	\$ 216,666	\$ 228,805
	2000 Median Rent	\$ 802	\$ 750	\$ 666

This report was produced using data from private and government sources deemed to be reliable. The information herein is provided without representation or warranty.

FULL DEMOGRAPHIC PROFILE

1990 - 2000 Census, 2007 Estimates & 2012 Projections

Calculated using Proportional Block Groups



Lat/Lon: 41.847263/-87.9014315

July 2010

RF1

2201-2237 S Wolf Rd Hillside, Illinois		1.00 mi radius	3.00 mi radius	5.00 mi radius
LABOR FORCE	2007 Est. Labor: Population Age 16+	7,011	79,224	246,404
	2007 Est. Civilian Employed	59.2%	61.9%	62.2%
	2007 Est. Civilian Unemployed	4.5%	4.8%	4.7%
	2007 Est. in Armed Forces	-	0.0%	0.0%
	2007 Est. not in Labor Force	36.3%	33.4%	33.1%
	2007 Labor Force: Males	46.6%	46.8%	47.5%
	2007 Labor Force: Females	53.4%	53.2%	52.5%
OCCUPATION	2000 Occupation: Population Age 16+	4,227	49,694	152,380
	2000 Mgmt, Business, & Financial Operations	19.1%	18.2%	16.8%
	2000 Professional and Related	23.9%	22.8%	21.8%
	2000 Service	7.0%	9.7%	10.8%
	2000 Sales and Office	35.5%	31.2%	30.7%
	2000 Farming, Fishing, and Forestry	0.1%	0.1%	0.1%
	2000 Construction, Extraction, & Maintenance	4.7%	5.6%	6.0%
	2000 Production, Transport, & Material Moving	9.8%	12.5%	13.8%
	2000 Percent White Collar Workers	78.5%	72.2%	69.3%
2000 Percent Blue Collar Workers	21.5%	27.8%	30.7%	
TRANSPORTATION TO WORK	2000 Drive to Work Alone	84.7%	77.5%	75.2%
	2000 Drive to Work in Carpool	4.6%	7.8%	9.4%
	2000 Travel to Work by Public Transportation	5.9%	9.1%	8.9%
	2000 Drive to Work on Motorcycle	-	0.0%	0.0%
	2000 Walk or Bicycle to Work	2.2%	2.1%	3.1%
	2000 Other Means	-	0.3%	0.5%
	2000 Work at Home	2.6%	3.1%	3.0%
TRAVEL TIME	2000 Travel to Work in 14 Minutes or Less	25.7%	22.3%	24.9%
	2000 Travel to Work in 15 to 29 Minutes	36.9%	32.4%	31.0%
	2000 Travel to Work in 30 to 59 Minutes	30.4%	36.0%	34.9%
	2000 Travel to Work in 60 Minutes or More	7.0%	9.3%	9.2%
	2000 Average Travel Time to Work	23.5	26.8	26.3
CONSUMER EXPENDITURE	2007 Est. Total Household Expenditure (in Millions)	\$ 198.5	\$ 2,462.3	\$ 7,429.5
	2007 Est. Apparel	\$ 9.4	\$ 118.8	\$ 359.3
	2007 Est. Contributions & Gifts	\$ 13.3	\$ 174.4	\$ 529.1
	2007 Est. Education & Reading	\$ 5.6	\$ 73.9	\$ 224.7
	2007 Est. Entertainment	\$ 11.2	\$ 139.3	\$ 420.2
	2007 Est. Food, Beverages & Tobacco	\$ 31.0	\$ 379.6	\$ 1,145.7
	2007 Est. Furnishings And Equipment	\$ 9.0	\$ 112.1	\$ 337.2
	2007 Est. Health Care & Insurance	\$ 14.0	\$ 170.1	\$ 512.6
	2007 Est. Household Operations & Shelter & Utilities	\$ 59.2	\$ 737.5	\$ 2,226.8
	2007 Est. Miscellaneous Expenses	\$ 3.3	\$ 39.9	\$ 120.2
	2007 Est. Personal Care	\$ 2.9	\$ 35.2	\$ 106.3
	2007 Est. Transportation	\$ 39.6	\$ 481.5	\$ 1,447.5

This report was produced using data from private and government sources deemed to be reliable. The information herein is provided without representation or warranty.