

311 East Green Street

New Construction Opportunity Available in Champaign, IL



Located in the
University of
Illinois
Campustown
Business
District

AVAILABLE for LEASE or BTS

- Up to 11,669 SF of street level retail space available
- Excellent opportunity and ideally situated to serve the dense student population
- Located on the University of Illinois at Urbana-Champaign campus with its nearly 42,000 student and more than 8,500 faculty and staff
- Located next to a new apartment complex with 110 units (currently housing 416 students) and 213 parking spaces
- Traffic Counts (VPD):
 - 12,200 on Green Street
 - 8,100 on 4th Street
- Area co-tenants include Urban Outfitters, Walgreens, IHOP, Flat Top Grill, Chipotle, Qdoba, Potbelly, Noodles & Company, Jimmy John's, Panera, Pita Pit, Pizza Hut, Penn Station, Cold Stone Creamery, and Starbucks

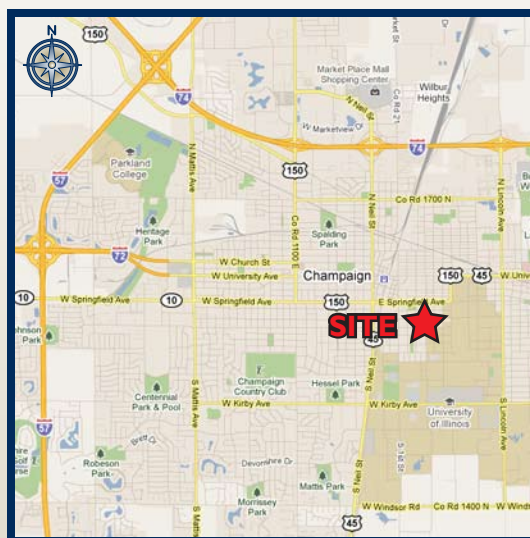

Brett Zimmerman
312.254.0720
bzimmerman@sierraus.com

640 North LaSalle Boulevard
Suite 410
Chicago, IL 60654

888.656.7744 (toll-free)
312.422.7745 (fax)

www.SierraUS.com

Project Leasing • Restaurant & Entertainment • Tenant Representation
Urban Retail • Office Brokerage • Asset Management





311 East Green Street
Champaign, IL
photos of site



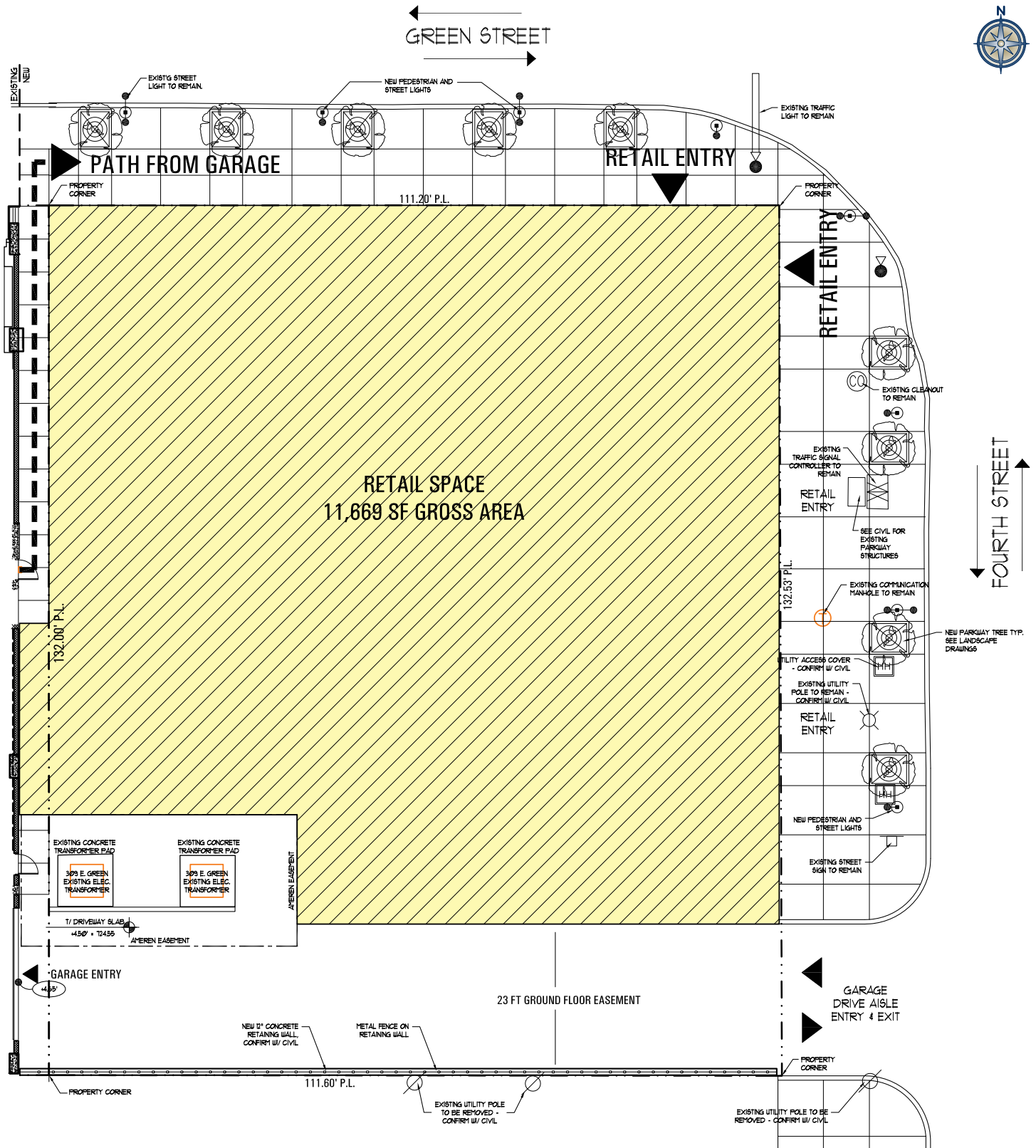

311 East Green Street
 Champaign, IL
 lot plan



ILLINOIS

Campus Map

The designation in parentheses following the number and name of each building indicates the map coordinates at which it can be found. An asterisk (*) indicates that a building is not included on this map.

- # Building Name (Coordinates)
- A1 Abbott Power Plant (D1)
- A2 Advanced Computation Bldg (B5)
- A3 Aeronautical Lab A (B5)
- A4 African-American Cultural Prog (D5)
- A5 Afro-American Studies & Rsch Prog (D5)
- A6 Agricultural Bioprocess Lab (E5)
- A8 Ag Engineering Sci Bldg (E4)
- A9 Agriculture Services Bldg (G4)
- A10 Ag Services Warehouse (G4)
- A11 Agronomy/Plant Pathology Farm (G4)
- A12 Agronomy Seed House (G4)
- A13 Agronomy Soybean Rsch Farm (G5)
- A14 Altgeld Hall (C4)
- A16 Animal Science Barns (G3)
- A17 Animal Sciences Lab (D5)
- A18 Arcade Bldg (C4)
- A19 Architecture Bldg (D4)
- A20 Armory (D3)
- A21 Armory Avenue Warehouse (D1)
- A22 Art & Design Bldg (E3)
- A23 Art Studios (H1) *
- A24 Assembly Hall (F3)
- A25 Astronomy Bldg (B5)
- A26 Atkins Tennis Ctr (F4)
- A27 Atmospheric Sciences Bldg (B6)
- A28 Arboretum - Hartley Gardens (F6)
- A29 Admin Info Tech Serv Bldg (H2) *
- A30 Admissions and Records (C6)
- A31 Art E Annex, Studio 2 (E5)
- A32 Art E Annex, Studio 1 (E5)
- A33 ACES Library & Info Center (D5)
- A34 Atmospheric Sciences Annex 1 (B5)
- A35 Atmospheric Sciences Annex 2 (B5)
- A36 Asian American Studies Bldg (D5)
- B1 Beckman Institute (A4)
- B2 Beckwith Hall (C2)
- B3 Beef Barns (G3)
- B4 Bevier Hall (D5)
- B5 Biological Control Lab (G1)
- Buell Hall—see T4
- B6 Building Rsch Council (G1)
- B7 Burnside's Rsch Lab (E5)
- B8 Burrill Hall (C5)
- B9 Bielfeldt Athletic Admin Bldg (F3)
- B10 Biomedical Magnetic Resonance Facility (H5) *
- C1 Campus Recreation Ctr East (D5)
- C2 Campus Rec Outdoor Ctr (D2)
- Career Ctr—see A18
- C3 Center for Advanced Study (C6)
- C4 Central Receiving Bldg (F1)
- C5 Ceramics Bldg (B5)
- C6 Chemical & Life Sci Lab (C5)
- C7 Chemistry Annex (C5)
- C8 Child Development Lab (D5)
- C9 Children's Rsch Ctr (I2) *
- C10 Ceramics Kiln House (C5)
- C11 Claims Management Ofc (C4)
- C12 Clark Hall Housing Admin (D3)
- C13 Coble Hall (C4)
- C14 Colonel Wolfe School (B3)
- Commerce West Bldg—see W7
- C15 Child Development Lab Expanded (D5)
- C16 Coordinated Science Lab (A4)
- C17 Computing Applications Bldg (B4)
- C18 Credit Union Bldg (H2) *
- C20 Campbell Hall for Public Telecommunications (A5)
- C21 CNI/Prairienet (C4)

- C22 Children & Family Rsch Ctr (D5)
- D1 Dairy Experimental Round Barns (G5)
- D2 Dairy Science Rsch Farm (H6) *
- D3 Dance Studio (D6)
- D4 Davenport Hall (C5)
- D5 David Kinley Hall (D4)
- D6 Digital Computer Lab (B4)
- D7 Duplicating/Quick Copy Bldg (G4)
- D8 Dance Admin Bldg (D6)
- East Asian Languages & Cultures—see F5
- E2 Education Bldg (E4)
- Electrical & Computer Engin Lab—see E11
- E3 Engineering Hall (B4)
- E4 Engineering Sr Design Studio (B6)
- E5 Engineering Sciences Bldg (B5)
- E6 English Bldg (C4)
- Environmental & Ag Sci Bldg—see N13
- E8 Environmental Health & Safety (B6)
- E11 Everitt Lab (B4)
- E12 Eichelberger Field (F5)
- F1 Fire Service Inst Bldg (I1) *
- F3 Flagg Hall (E3)
- F4 Foellinger Auditorium (D4)
- F5 Foreign Languages Bldg (D4)
- F7 Freer Hall (D5)
- G1 Garage/Car Pool (F1)
- G3 General Curriculum Bldg (C3)
- G4 Geological Survey Lab (D1)
- G5 Govt & Public Affairs, Inst of (D5)
- G6 Grainger Engin Library Info Ctr (B4)
- G7 Gregory Hall (D4)
- H1 Harding Band Bldg (D4)
- H2 Harker Hall (C4)
- Hartley Gardens—see A28
- H3 Hallene Gateway (C6)
- H5 Henry Admin Bldg (C4)
- H8 Honors Program (D5)
- H9 Housing Food Stores (E1)
- H10 Huff Hall (D3)
- H11 Hydraulic Engin Lab & Warehouse #1 (B5)
- H12 Hydrosystems Lab (A5)
- I1 Ice Arena (D3)
- I2 Illini Hall (C4)
- Illini Orange SnackBar—see S3
- I3 Illini Union (C4)
- I4 Illini Union Bookstore (C4)
- I5 Illinois Program for Research in the Humanities (E6)
- I6 Illinois Field (F4)
- Illinois Library Computer System Ofc—see L6
- International Student Affairs—see T9
- I8 Intensive English Institute (D5)
- I9 International Studies Bldg (C3)
- I10 IMPE (E2)
- I11 Imported Swine Rsch Ctr (H2) *
- I12 Irwin Indoor Football Practice Facility (E3)
- I13 Irwin Academic Services Ctr (D3)
- J1 Japan House (G6)
- K1 Kenney Gym (B4)
- K2 Kenney Gym Annex (B4)
- K3 Krannert Art Museum & Kinkead Pavillion (E3)
- K4 Krannert Ctr for the Performing Arts (C5)
- L1 La Casa Cultural Latina (D5)
- L2 Labor & Industrial Relations, Inst of (D3)
- Large Animal Clinic—see V5
- L3 Law Bldg (E3)
- L4 Levis Faculty Ctr/Visitor's Ctr (C5)
- L5 Library (D4)
- L6 Library & Information Science (C3)
- L7 Lincoln Hall (D4)
- L8 Loomis Lab (B5)
- L9 Latina/o Studies (C4)
- M1 Madigan Lab (D5)
- M2 Mailing Ctr (F1)
- M3 Management Information Div (C4)
- M4 Merriam Lab (C4)

- M5 McKinley Health Ctr (E6)
- M6 Meat Science Lab (E5)
- M7 Mechanical Engineering Bldg (B5)
- M8 Mechanical Engineering Lab (B5)
- M9 Medical Sciences Bldg (C5)
- M10 Memorial Stadium (E3)
- M12 Materials Science & Engin Bldg (B5)
- M13 Micro & Nanotechnology Lab (B4)
- M14 Moorman Swine Rsch Farm (H3) *
- M15 Morrill Hall (C5)
- M16 Mumford Hall (D4)
- M17 Mumford House (E4)
- M18 Music Annex (D6)
- M19 Music Bldg (D5)
- M20 Minority Student Affairs Academic Services Ctr (D5)
- N1 Natural History Bldg (C5)
- N2 Natural Resources Bldg (E4)
- N3 Natural Resources Studies Annex (G1)
- N4 Newmark Lab (B4)
- N5 Noble Hall (E3)
- N6 North Campus Chiller Plant (A5)
- N7 Noyes Lab (C5)
- N8 Nuclear Engineering Lab (B5)
- N9 Nuclear Physics Lab (E1)
- N10 Nuclear Radiations Lab (B5)
- N11 NCSA (A5)
- N12 Nursing, School of (C5)
- N13 National Soybean Rsch Ctr (E5)
- N14 Nevada St Computing Serv (D5)
- N15 Native American House (D5)
- O1 Observatory (D5)
- O2 Ornamental Horticulture Bldg (E5)
- O3 Optical Physics & Engineering Lab (B4)
- O4 Oregon St Computing Serv (D6)
- P1 Parking Structures (C3, A5)
- P2 Personnel Services Bldg (D2)
- P3 Physical Plant Service Bldg (E1)
- P4 Physiology Rsch Lab (H2) *
- Plant & Animal Biotechnology Lab—see M1
- P5 Plant Clinic (G4)
- P6 Plant Sciences Lab (E5)
- P7 Plant Services Bldg NE (B5)
- P8 Police Training Institute (D3)
- P9 Poultry Farm (F4)
- P10 President's House (F6)
- P11 Psychology Bldg (C4)
- P12 Public Safety (B5)
- P13 Printing Services Imaging Bldg (D2)
- P14 Printing Services Bldg (D2)
- P15 Professional Arts Bldg (B4)
- P16 Parking Structure & Fire Substation (D5)
- P17 Presidential Towers/University Inn (C3)
- P18 Plant Services Storage Bldg (B5)
- R1 Rehabilitation Education Ctr (D1)
- R2 Roger Adams Lab (C5)
- R3 Richmond Studio (A5)
- S1 Sheep Barns (G2)
- Small Animal Clinic—see V5
- Small Homes Council—see B6
- S2 Smith Hall (D4)
- S3 Snack Bar, Illini Orange (D3)
- S4 Social Work, School of (D5)
- S5 Spurlock Museum (C6)
- S6 Special Materials Storage Facility (H1) *
- S7 Speech & Hearing Clinic (C4)
- S8 State Regional Ofc Bldg (H2) *
- S9 Stock Pavilion (E4)
- Student Services—see A18 or T9
- S10 Structural Warehouse (B5)
- S11 Superconductivity Ctr (B5)
- S12 Survey Rsch Lab (C4)
- S13 Surveying Bldg (D4)
- S14 Swanlund Admin Bldg (C4)
- S15 Siebel Ctr for Computer Science (B5)
- S16 Seitz Materials Rsch Lab (B5)
- S17 Social Work Annex (C5)
- T1 Talbot Lab (B4)
- T3 Technology Commercialization Bldg (G4)
- T4 Temple Hoynes Buell Hall (E4)

- T5 Track & Soccer Stadium (F4)
 - T6 Transportation Bldg (B5)
 - T7 Turner Hall (E5)
 - T8 Turner Hall Greenhouses (E5)
 - T9 Turner Student Services Bldg (C4)
 - T10 Taft House (F5)
 - U1 Undergraduate Library (D4)
 - U2 University High School (B5)
 - U3 University High School Gym (B5)
 - U5 University Press Bldg (E1)
 - Urban & Regional Planning—see T4
 - University Inn—see P17
 - U6 Ubben Basketball Facility (F3)
 - V1 Vegetable Crops Bldg (D5)
 - V2 Vet Med Basic Sciences Bldg (G5)
 - V3 Vet Med Feed Storage Bldg (G5)
 - V4 Vet Med Surgery & Obstetrics Lab (G5)
 - V5 Vet Teaching Hospital (G5)
 - Visitor's Center—see L4
 - V6 Vivarium, Shelford (B4)
 - V7 Volatile Storage Bldg (E1)
 - W1 Water Survey Rsch Ctr (I2) *
 - W3 Women's Studies (C4)
 - W4 Wood Engineering Lab (E5)
 - W6 Waste Mgt Rsch Ctr (H1) *
 - W7 Wohlers Hall (D4)
- UNIVERSITY RESIDENCE HALLS**
- Undergraduate Halls**
- Champaign Residence Halls**
- BR Barton (D3)
- FR Forbes (D2)
- GR Garner (D3)
- HP Hopkins (E2)
- LN Lundgren (D3)
- SC Scott (E2)
- SN Snyder (E3)
- TF Taft (E3)
- VD Van Doren (E3)
- WS Weston (D3)
- Urbana North Residence Halls**
- AL Allen (D6)
- BS Busey (D5)
- EV Evans (D5)
- LA Lincoln Avenue (Shelden-Leonard) (D6)
- Illinois Street**
- TW Townsend (C6)
- WR Wardall (C5)
- Urbana South Residence Halls**
- Pennsylvania Avenue**
- BB Babcock (E6)
- BL Blaisdell (E6)
- CR Carr (E6)
- SD Saunders (E6)
- Florida Avenue
- OG Oglesby (E6)
- TR Trelease (E6)
- Graduate Halls**
- DN Daniels (B5)
- SM Sherman (C3)
- Family Housing**
- GG Goodwin/Green Apts (C5)
- OD Orchard Downs Apts (East of F6)
- Certified Housing—Private**
- 1P Armory House (D3)
- 2P Bromley Hall (C3)
- 4P Brown House on Coler (C6)
- 5P Christian Campus House (C6)
- 6P Europa House (C6)
- 7P Hendrick House (B6)
- 8P Illini Tower (D3)
- 9P Koinonia (C3)
- 10P McKinley Men's Residence Hall (C3)
- 11P Nevada House (D6)
- 12P Newman Hall (D4)
- 13P Newman House (D4)
- 14P Presby House (C3)
- 15P Stratford House (C3)
- 16P University YMCA (D4)

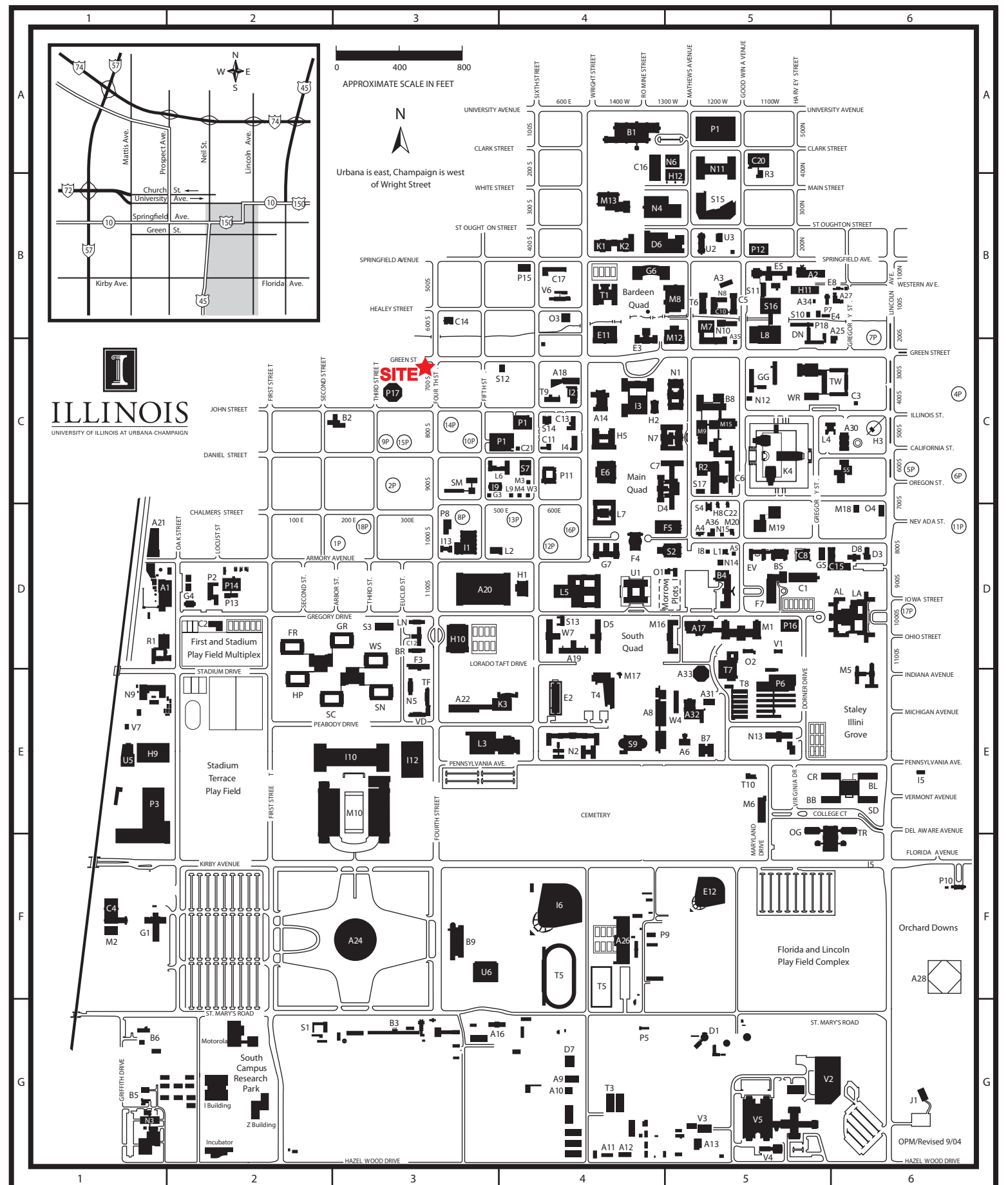

FULL PROFILE

1990 - 2000 Census, 2010 Estimates with 2015 Projections
 Calculated using Proportional Block Groups



Lat/Lon: 40.10999/-88.23398

311 E. Green St. Champaign, IL		0.25 Mile	0.5 Mile	1 Mile	1.5 Miles
POPULATION	2010 Estimated Population	6,423	16,953	33,014	49,890
	2015 Projected Population	7,796	18,529	34,703	51,305
	2000 Census Population	5,150	14,847	29,530	46,147
	1990 Census Population	4,976	15,251	31,189	47,563
	Historical Annual Growth 1990 to 2010	1.5%	0.6%	0.3%	0.2%
	Projected Annual Growth 2010 to 2015	4.3%	1.9%	1.0%	0.6%
HOUSEHOLDS	2010 Est. Households	2,075	6,032	11,461	18,245
	2015 Proj. Households	2,751	6,899	12,446	19,347
	2000 Census Households	1,625	5,299	10,430	17,061
	1990 Census Households	1,454	4,674	9,500	16,175
	Historical Annual Growth 1990 to 2010	2.1%	1.5%	1.0%	0.6%
	Projected Annual Growth 2010 to 2015	6.5%	2.9%	1.7%	1.2%
AGE	2010 Est. Population 0 to 9 Years	2.7%	2.8%	4.3%	6.1%
	2010 Est. Population 10 to 19 Years	17.9%	17.7%	19.7%	18.8%
	2010 Est. Population 20 to 29 Years	65.0%	65.2%	55.1%	46.4%
	2010 Est. Population 30 to 44 Years	5.7%	6.6%	9.5%	12.4%
	2010 Est. Population 45 to 59 Years	3.4%	3.7%	5.6%	8.4%
	2010 Est. Population 60 to 74 Years	2.3%	2.2%	3.3%	4.6%
	2010 Est. Population 75 Years Plus	3.0%	2.0%	2.5%	3.2%
	2010 Est. Median Age	21.6	21.7	22.9	24.9
MARITAL STATUS & SEX	2010 Est. Male Population	54.2%	57.0%	57.1%	55.8%
	2010 Est. Female Population	45.8%	43.0%	42.9%	44.2%
	2010 Est. Never Married	86.9%	87.0%	81.2%	71.9%
	2010 Est. Now Married	1.8%	2.3%	7.3%	15.0%
	2010 Est. Separated or Divorced	10.7%	10.0%	10.0%	10.7%
	2010 Est. Widowed	0.7%	0.7%	1.6%	2.5%
INCOME	2010 Est. HH Income \$200,000 or More	-	-	0.3%	0.9%
	2010 Est. HH Income \$150,000 to \$199,999	-	-	0.5%	1.4%
	2010 Est. HH Income \$100,000 to \$149,999	-	-	2.5%	5.6%
	2010 Est. HH Income \$75,000 to \$99,999	0.3%	0.7%	2.2%	4.4%
	2010 Est. HH Income \$50,000 to \$74,999	2.2%	3.0%	5.6%	8.6%
	2010 Est. HH Income \$35,000 to \$49,999	2.8%	3.0%	6.1%	8.2%
	2010 Est. HH Income \$25,000 to \$34,999	7.1%	7.4%	9.1%	9.8%
	2010 Est. HH Income \$15,000 to \$24,999	22.8%	21.2%	19.9%	18.3%
	2010 Est. HH Income \$0 to \$14,999	64.7%	64.6%	53.8%	42.8%
	2010 Est. Average Household Income	\$13,246	\$13,787	\$22,036	\$33,612
	2010 Est. Median HH Income	\$10,681	\$10,568	\$16,097	\$25,316
2010 Est. Per Capita Income	\$13,913	\$13,614	\$15,928	\$19,227	
2010 Est. Number of Businesses	185	434	1,269	2,025	
2010 Est. Total Number of Employees	7,615	17,180	29,911	43,001	

This report was produced using data from private and government sources deemed to be reliable. The information herein is provided without representation or warranty.

FULL PROFILE

1990 - 2000 Census, 2010 Estimates with 2015 Projections
 Calculated using Proportional Block Groups



Lat/Lon: 40.10999/-88.23398

311 E. Green St.

Champaign, IL

	0.25 Mile	0.5 Mile	1 Mile	1.5 Miles	
RACE	2010 Est. White Population	77.9%	74.6%	68.5%	68.0%
	2010 Est. Black Population	4.5%	6.1%	11.0%	13.7%
	2010 Est. Asian & Pacific Islander	14.8%	16.2%	17.4%	15.4%
	2010 Est. American Indian & Alaska Native	0.3%	0.3%	0.2%	0.3%
	2010 Est. Other Races Population	2.6%	2.9%	2.8%	2.7%
HISPANIC	2010 Est. Hispanic Population	504	1,499	2,644	3,667
	2010 Est. Hispanic Population Percent	7.8%	8.8%	8.0%	7.4%
	2015 Proj. Hispanic Population Percent	8.8%	10.1%	9.3%	8.7%
	2000 Hispanic Population Percent				
EDUCATION (Adults 25 or Older)	2010 Est. Adult Population (25 Years or Older)	1,502	4,316	10,859	20,492
	2010 Est. Elementary (0 to 8)	8.7%	6.0%	3.5%	3.2%
	2010 Est. Some High School (9 to 11)	1.5%	2.4%	3.5%	4.2%
	2010 Est. High School Graduate (12)	16.4%	14.2%	13.5%	13.7%
	2010 Est. Some College (13 to 16)	5.2%	6.5%	10.1%	12.5%
	2010 Est. Associate Degree Only	4.6%	4.5%	4.5%	4.6%
	2010 Est. Bachelor Degree Only	38.5%	34.4%	28.5%	25.9%
	2010 Est. Graduate Degree	25.2%	32.0%	36.4%	36.0%
HOUSING	2010 Est. Total Housing Units	2,222	6,470	12,398	19,910
	2010 Est. Owner Occupied Percent	0.7%	1.0%	10.0%	21.0%
	2010 Est. Renter Occupied Percent	92.7%	92.2%	82.5%	70.6%
	2010 Est. Vacant Housing Percent	6.6%	6.8%	7.6%	8.4%
HOMES BUILT BY YEAR	2000 Homes Built 1999 to 2000	0.7%	1.7%	1.4%	1.1%
	2000 Homes Built 1995 to 1998	8.5%	8.0%	6.6%	5.9%
	2000 Homes Built 1990 to 1994	10.5%	11.7%	8.9%	6.2%
	2000 Homes Built 1980 to 1989	26.7%	24.4%	17.8%	13.2%
	2000 Homes Built 1970 to 1979	26.5%	24.8%	19.6%	17.4%
	2000 Homes Built 1960 to 1969	14.7%	15.0%	13.8%	13.6%
	2000 Homes Built 1950 to 1959	6.1%	7.1%	10.3%	12.2%
	2000 Homes Built Before 1949	6.3%	7.2%	21.6%	30.5%
HOME VALUES	2000 Home Value \$1,000,000 or More	-	2.0%	0.5%	0.1%
	2000 Home Value \$500,000 to \$999,999	-	-	0.3%	0.5%
	2000 Home Value \$400,000 to \$499,999	-	-	0.2%	0.5%
	2000 Home Value \$300,000 to \$399,999	-	-	1.6%	1.5%
	2000 Home Value \$200,000 to \$299,999	-	-	3.1%	4.7%
	2000 Home Value \$150,000 to \$199,999	-	-	4.4%	7.5%
	2000 Home Value \$100,000 to \$149,999	-	9.9%	18.5%	22.2%
	2000 Home Value \$50,000 to \$99,999	-	25.3%	48.6%	46.9%
	2000 Home Value \$25,000 to \$49,999	-	22.6%	21.4%	14.8%
	2000 Home Value \$0 to \$24,999	100.0%	40.2%	1.4%	1.1%
	2000 Median Home Value	\$12,499	\$46,202	\$87,217	\$93,965
	2000 Median Rent	\$455	\$398	\$422	\$411

This report was produced using data from private and government sources deemed to be reliable. The information herein is provided without representation or warranty.

FULL PROFILE

1990 - 2000 Census, 2010 Estimates with 2015 Projections
 Calculated using Proportional Block Groups



Lat/Lon: 40.10999/-88.23398

311 E. Green St. Champaign, IL		0.25 Mile	0.5 Mile	1 Mile	1.5 Miles
LABOR FORCE	2010 Est. Labor: Population Age 16+	5,706	15,081	28,620	42,538
	2010 Est. Civilian Employed	41.2%	44.3%	47.9%	51.1%
	2010 Est. Civilian Unemployed	9.4%	8.7%	8.4%	7.1%
	2010 Est. in Armed Forces	0.2%	0.3%	0.2%	0.2%
	2010 Est. not in Labor Force	49.2%	46.7%	43.5%	41.6%
	2010 Labor Force: Males	54.5%	57.6%	57.4%	56.0%
	2010 Labor Force: Females	45.5%	42.4%	42.6%	44.0%
OCCUPATION	2000 Occupation: Population Age 16+	2,332	7,130	14,641	23,262
	2000 Mgmt, Business, & Financial Operations	5.3%	4.8%	5.7%	7.2%
	2000 Professional & Related	34.5%	36.3%	40.5%	41.0%
	2000 Service	25.9%	24.6%	21.1%	19.3%
	2000 Sales and Office	27.5%	27.3%	24.6%	23.1%
	2000 Farming, Fishing, and Forestry	1.0%	0.8%	0.5%	0.3%
	2000 Construction, Extraction, & Maintenance	1.8%	1.5%	2.3%	2.7%
	2000 Production, Transport, & Material Moving	4.0%	4.7%	5.3%	6.3%
	2000 Percent White Collar Workers	67.3%	68.4%	70.8%	71.4%
2000 Percent Blue Collar Workers	32.7%	31.6%	29.2%	28.6%	
TRANSPORTATION TO WORK	2000 Drive to Work Alone	35.1%	34.5%	38.3%	44.9%
	2000 Drive to Work in Carpool	4.6%	5.3%	6.9%	8.5%
	2000 Travel to Work by Public Transportation	7.2%	8.5%	10.2%	10.4%
	2000 Drive to Work on Motorcycle	0.4%	0.4%	0.3%	0.2%
	2000 Walk or Bicycle to Work	48.9%	48.4%	41.1%	32.4%
	2000 Other Means	0.8%	0.5%	0.6%	0.5%
	2000 Work at Home	3.0%	2.5%	2.5%	3.2%
TRAVEL TIME	2000 Travel to Work in 14 Minutes or Less	70.3%	67.9%	66.8%	64.6%
	2000 Travel to Work in 15 to 29 Minutes	24.0%	25.4%	26.5%	28.0%
	2000 Travel to Work in 30 to 59 Minutes	4.7%	5.9%	5.5%	5.8%
	2000 Travel to Work in 60 Minutes or More	0.9%	0.8%	1.3%	1.7%
	2000 Average Travel Time to Work	10.3	11.0	11.6	12.1
CONSUMER EXPENDITURE	2010 Est. Total Household Expenditure	\$45.2 M	\$133 M	\$310 M	\$614 M
	2010 Est. Apparel	\$2.24 M	\$6.60 M	\$15.1 M	\$29.6 M
	2010 Est. Contributions & Gifts	\$2.35 M	\$7.02 M	\$17.2 M	\$36.3 M
	2010 Est. Education & Reading	\$1.38 M	\$4.08 M	\$9.05 M	\$17.6 M
	2010 Est. Entertainment	\$2.35 M	\$6.92 M	\$16.4 M	\$33.2 M
	2010 Est. Food, Beverages & Tobacco	\$7.99 M	\$23.5 M	\$53.2 M	\$102 M
	2010 Est. Furnishings & Equipment	\$1.67 M	\$4.97 M	\$12.1 M	\$25.2 M
	2010 Est. Health Care & Insurance	\$3.51 M	\$10.4 M	\$23.7 M	\$45.8 M
	2010 Est. Household Operations & Shelter & Utilities	\$13.7 M	\$40.4 M	\$93.5 M	\$185 M
	2010 Est. Miscellaneous Expenses	\$807 K	\$2.39 M	\$5.49 M	\$10.7 M
	2010 Est. Personal Care	\$692 K	\$2.04 M	\$4.66 M	\$9.11 M
	2010 Est. Transportation	\$8.52 M	\$25.1 M	\$59.3 M	\$119 M

This report was produced using data from private and government sources deemed to be reliable. The information herein is provided without representation or warranty.